

## Connection Details of Cable Assembly Wired for Channel A

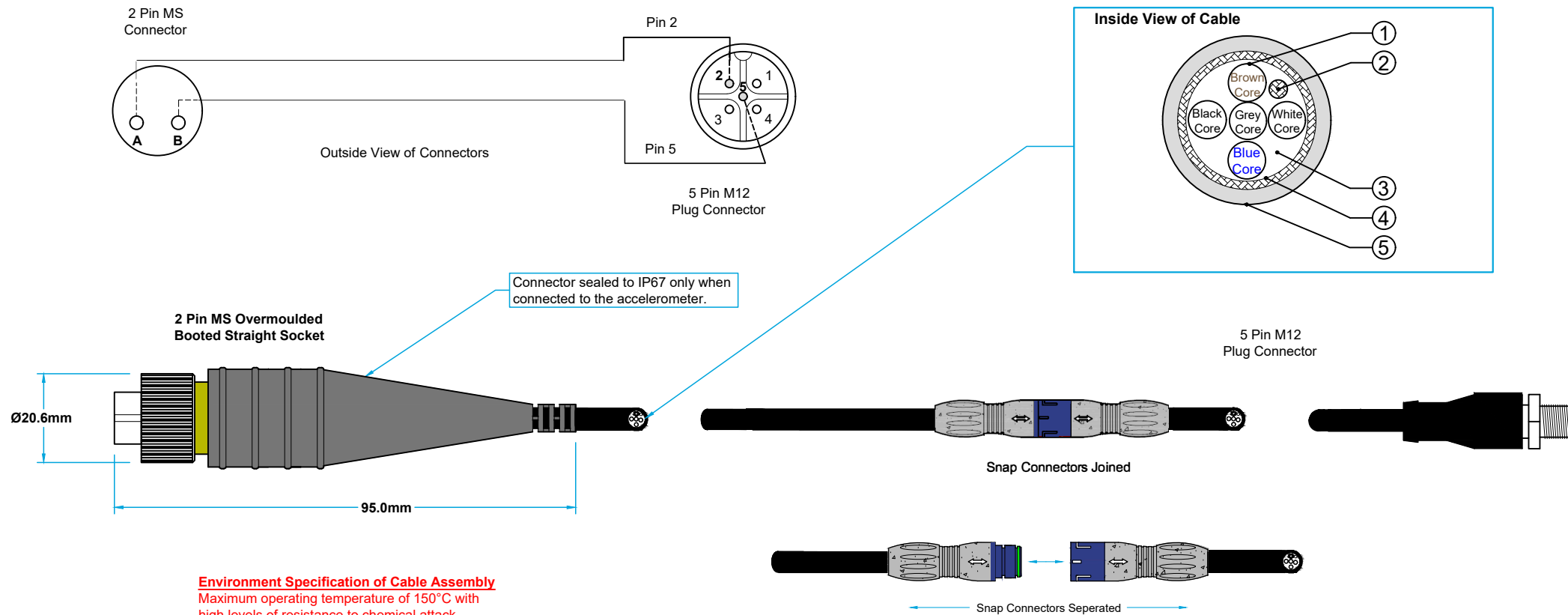

**Environment Specification of Cable Assembly**  
Maximum operating temperature of 150°C with high levels of resistance to chemical attack.

Materials of Cable				
Pos	Description	Dimension	Overall Diameter	Remarks
Cable description: LiF9YHC11YH 5 x 0.34mm <sup>2</sup> with drain wire qualified for drag chains acc. to UL/CSA FT-2		Bending radius	min. 12 x outer-Ø min. 5 x outer-Ø	Moving Fixed installation
1.	Conductor, bare soft copper wire		0.10mm	acc. to VDE 0295, cl 6
2.	Screen wire, tinned copper		0.20mm	
3.	Stranding, 5 cores surrounding a woollen inner core			Length of lay approx 43mm drain wire
4.	Screen, tinned copper			Coverage: 84% min
5.	Outer sheath, Polyurethane PUR UL Flame retardant acc. to VDE 0482-267-2-1 Halogen free, Oil resistant acc., free of silicone, chemicals and oils		5.6 ±0,2mm	Black RAL9005

Technical Data of Cable		
Technical Data	Values at 20°C	Unit
Resistance	≤57	Ω / km
Test voltage	2	KV
Normal voltage	300	V
Inductance	0.7	µH/m
Capacitance	Core/Core: 80	nF/km
	Core/Sheild: 120.0	
Temperature range	-30°C to + 90°C	Moving
	-40°C to + 90°C	Fixed installation