

# HS-200SRT Temperature Sensor

only PT100 temperature output via 2 Pin MS Connector

## Key Features

- PT100 Temperature output
- For use with data collector
- Customisable features

## Industries

Building services, Pulp and Paper,  
Mining, Metals, Utilities, Automotive,  
Water, Pharmaceutical

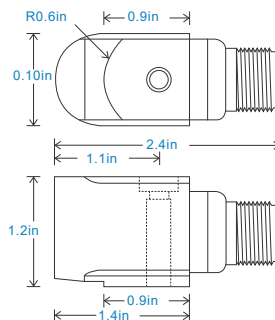

Connection Details

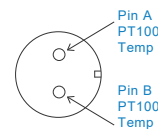

## Technical Performance

Temperature Output PT100 (100 Ohms)  
Isolation Base isolated

## Mechanical

Case Material Stainless Steel  
Mounting Torque 5.9ft. lbs  
Weight 7.05 oz. (nominal)  
Screened Cable Assembly see: [www.hansfordsensors.com](http://www.hansfordsensors.com) for options  
Connector HS-AA004 - non-booted  
HS-AA053 or HS-AA054 - booted  
Mounting Threads see: 'How To Order' table

## Electrical

## Environmental

Operating Temperature Range see: 'How To Order' table  
Sealing IP68  
EMC EN61326-1:2013

## Applications

Fans, Motors, Pumps, Compressors,  
Centrifuges, Conveyors, Air Handlers,  
Gearboxes, Rolls, Dryers, Presses,  
Cooling, VAC, Spindles, Machine Tooling,  
Process Equipment

Vibration sensor should be firmly fixed to a flat surface  
(spot face surface may be needed to be produced and  
cable anchored to sensor body.)

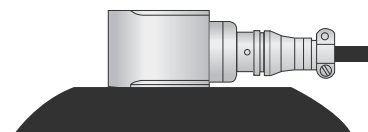

## How To Order

Product Prefix	Product Series										
HS - Hansford Sensors	200 - Industrial Temperature Sensor										
H	S	2	0	0	X	X	X	X	X	X	X
Extra Options (if required)		Temperature Range		Cable/Connector		Mounting Threads					
S - 90° Side Exit RT - Temperature Output PT100		100 - 32-212°F 150 - 32-300°F		01 - PUR 02 - Braided 07 - Silicon 08 - Flame Retardant 50 - 2 Pin MS 54 - M12		01 - 1/4-28" UNF Female 02 - 1/4-28" UNF Male 05 - Quick Fit Female 06 - M6 x 1mm Male 08 - M8 x 1.25mm Male 10 - M10 x 1.5mm Male					



[www.hansfordsensors.com](http://www.hansfordsensors.com)  
[sales@hansfordsensors.com](mailto:sales@hansfordsensors.com)

We reserve the right to alter the specification of this product without prior notice  
TS856U.6

