

AC acceleration output via M12 Connector

Key Features

- Line drive
- Customisable features
- For use with data collector
- Side entry for easy access

Industries

Building services, Pulp and Paper,
Mining, Metals, Utilities, Automotive,
Water, Pharmaceutical

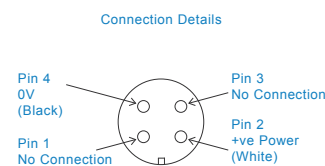
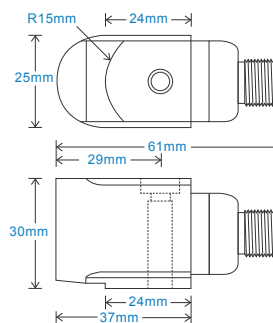

Technical Performance		Mechanical	
Mounted Base Resonance	see 'How To Order' table (nominal)	Case Material	Stainless Steel
Sensitivity	see: 'How To Order' table $\pm 10\%$	Sensing Element/Construction	PZT/Compression
	Nominal 80Hz at 22°C	Mounting Torque	8Nm
Frequency Response	2Hz (120cpm) to 10kHz (600kcpm) $\pm 5\%$	Mounting Bolt provided	see: 'How To Order' table x 30mm long
	1.5Hz (90cpm) to 12kHz (720kcpm) $\pm 10\%$	Weight	185gms (nominal) body only
	0.8Hz (48cpm) to 15kHz (900kcpm) $\pm 3\text{dB}$	Screened Cable Assembly	HS-AC010 - straight
Isolation	Base isolated		HS-AC011 - right angle
Range	see: 'How To Order' table	Mounting Threads	see: 'How To Order' table
Transverse Sensitivity	Less than 5%		

Electrical		Environmental	
Electrical Noise	0.1mg max	Operating Temperature Range	-55 to 140°C
Supply Voltage	7.5 - 24Volts DC	Sealing	IP67
Bias Current	3.5mA	Maximum Shock	5000g
Settling Time	2 seconds	EMC	EN61326-1:2013
Output Impedance	200 Ohms max.		
Case Isolation	>10 ⁸ Ohms at 500 Volts		

Typical Frequency Response

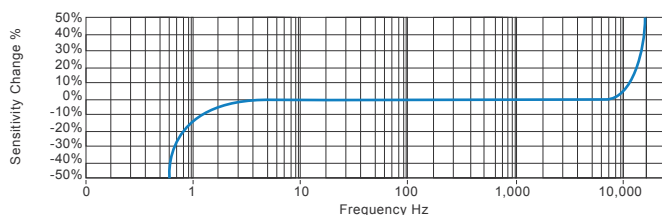

Applications

Fans, Motors, Pumps, Compressors,
Centrifuges, Conveyors, Air Handlers,
Gearboxes, Rolls, Dryers, Presses,
Cooling, VAC, Spindles, Machine Tooling,
Process Equipment

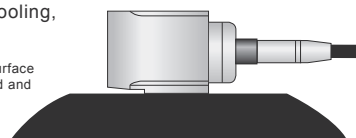

How To Order

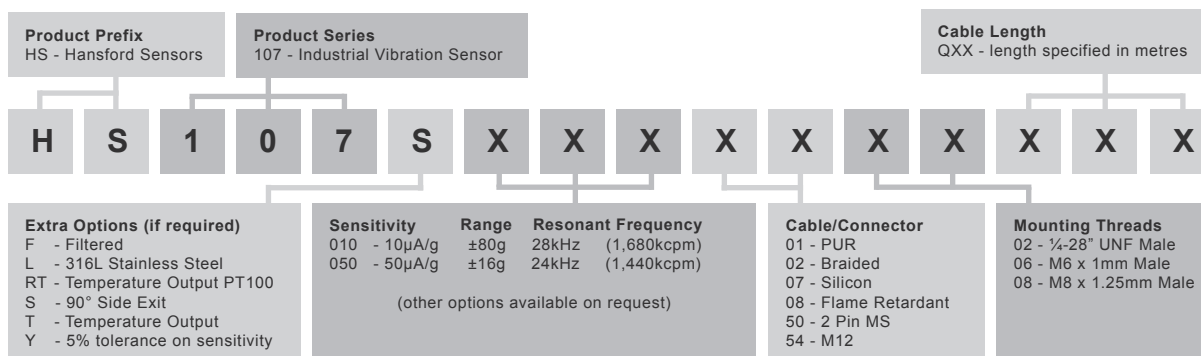

www.hansfordsensors.com
sales@hansfordsensors.com

We reserve the right to alter the specification of this product without prior notice

TS1099.2

