

HS-210S Temperature Sensor

only temperature output via 3 Pin MS Connector

Key Features

- Temperature output
- For use with data collector
- Side entry for easy access

Industries

Building services, Pulp and Paper,
Mining, Metals, Utilities, Automotive,
Water, Pharmaceutical

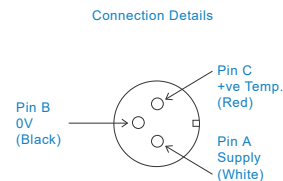
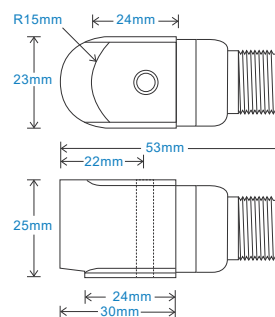

Technical Performance

Temperature Output 10 mV/°C standard 100°C - Option 150°C
Isolation Base isolated

Mechanical

Case Material Stainless Steel
Mounting Torque 8Nm
Mounting Bolt provided see: 'How To Order' table x 30mm long
Weight 125gms (nominal) body only
Screened Cable Assembly see: www.hansfordsensors.com for options
Connector HS-AA005 - non-booted
HS-AA068 or HS-AA069 - booted
Mounting Threads see: 'How To Order' table

Electrical

Operating Voltage 4-30 VDC

Environmental

Operating Temperature Range -55 to see: 'How To Order' table for max
Sealing IP68
EMC EN61326-1:2013

Applications

Fans, Motors, Pumps, Compressors,
Centrifuges, Conveyors, Air Handlers,
Gearboxes, Rolls, Dryers, Presses,
Cooling, VAC, Spindles, Machine Tooling,
Process Equipment

Vibration sensor should be firmly fixed to a flat surface
(spot face surface may be needed to be produced and
cable anchored to sensor body.)

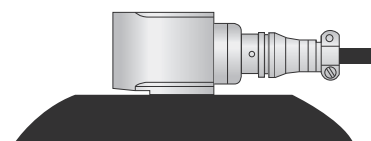

How To Order

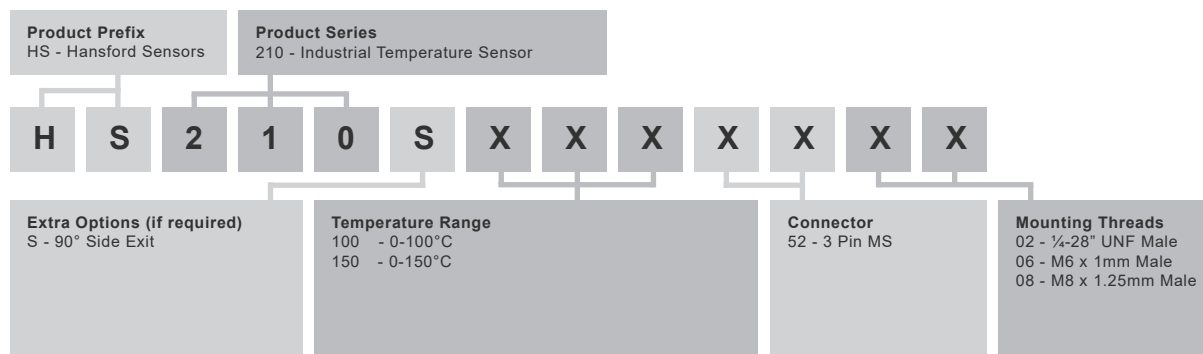

www.hansfordsensors.com
sales@hansfordsensors.com

We reserve the right to alter the specification of this product without prior notice
TS388.9

