

HS-104S Low Power Accelerometer

AC acceleration output via M12 Connector

Key Features

- Low voltage
- Ultra low power consumption
- Side entry for easy access

Industries

Building services, Pulp and Paper,
Mining, Metals, Utilities, Automotive,
Water, Pharmaceutical

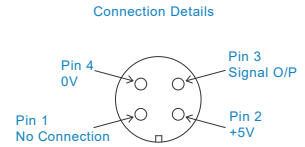
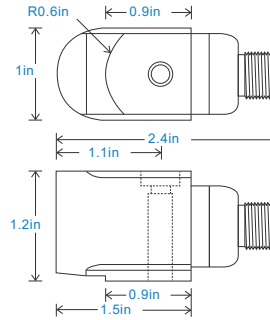

Technical Performance

Mounted Base Resonance	see 'How To Order' table (nominal)
Sensitivity	see: 'How To Order' table $\pm 10\%$ Nominal 80Hz at 72°F
Frequency Response	18cpm (0.3Hz) to 600kcpm (10kHz) $\pm 10\%$
Isolation	Base isolated
Range	see: 'How To Order' table @ 5V power
Transverse Sensitivity	Less than 5%
Amplitude Linearity	$\pm 1\%$

Mechanical

Case Material	Stainless Steel
Sensing Element/Construction	PZT/Shear
Mounting Torque	5.9ft. lbs
Mounting Bolt Provided	see: 'How To Order' table x 1.2in long
Weight	6.5 oz. (nominal)
Shielded Cable Assembly	HS-AC010 - straight HS-AC011 - right angle
Mounting Threads	see: 'How To Order' table

Electrical

Electrical Noise	< 500 μ g
Power Requirements	5V nominal (other voltages 1.8 to 24V on request)
Current Consumption	100 μ A nominal at 5V supply (60 μ A at 1.8V)
Bias Voltage	50% of supply voltage
Settling Time	1 second
Output Impedance	100 Ohms max.
Case Isolation	>10 ⁸ Ohms at 500 Volts

Environmental

Operating Temperature Range	-58 to 257°F
Sealing	IP67
Maximum Shock	5000g
EMC	EN61326-1:2013

Typical Frequency Response (at 100mV/g)

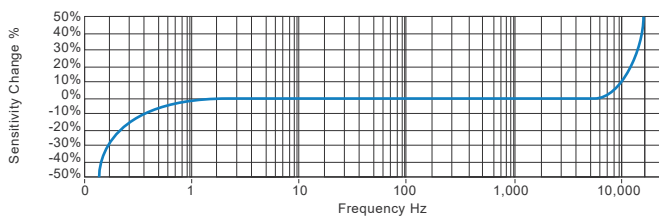

Applications

Fans, Motors, Pumps, Compressors,
Centrifuges, Conveyors, Air Handlers,
Gearboxes, Rolls, Dryers, Presses,
Cooling, VAC, Spindles, Machine Tooling,
Process Equipment

Vibration sensor should be firmly fixed to a flat surface
(spot face surface may be needed to be produced and
cable anchored to sensor body.)

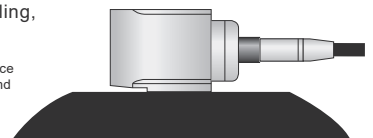

How To Order

Product Prefix	Product Series											
HS - Hansford Sensors	104 - Low Power Vibration Sensor											
H	S	1	0	4	S	X	X	X	X	X	X	X
Extra Options (if required)		Sensitivity		Range		Resonant Frequency		Cable/Connector		Mounting Threads		
F - Filtered		010 - 10mV/g		± 200 g		1,500kcpm (25kHz)		01 - PUR		02 - 1/4"-28" UNF Male		
L - 316L Stainless Steel		030 - 30mV/g		± 66 g		1,500kcpm (25kHz)		03 - Braided		06 - M6 x 1mm Male		
RT - Temperature Output PT100		050 - 50mV/g		± 40 g		1,500kcpm (25kHz)		07 - Silicon		08 - M8 x 1.25mm Male		
S - 90° Side Exit		100 - 100mV/g		± 20 g		1,500kcpm (25kHz)		13 - Flame Retardant				
T - Temperature Output		250 - 250mV/g		± 8 g		1,500kcpm (25kHz)		52 - 3 Pin MS				
		500 - 500mV/g		± 4 g		1,500kcpm (25kHz)		54 - M12				



www.hansfordsensors.com
sales@hansfordsensors.com

We reserve the right to alter the specification of this product without prior notice

TS391U.9

